

Detail D1-D1

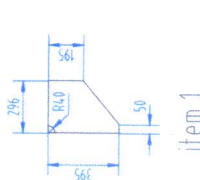
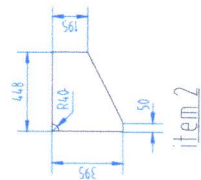
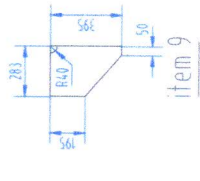
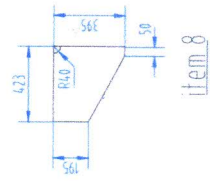
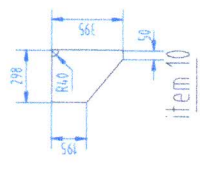
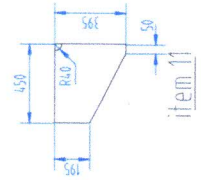
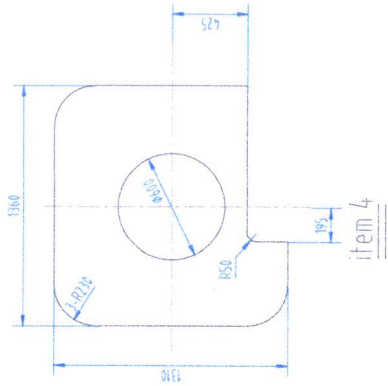
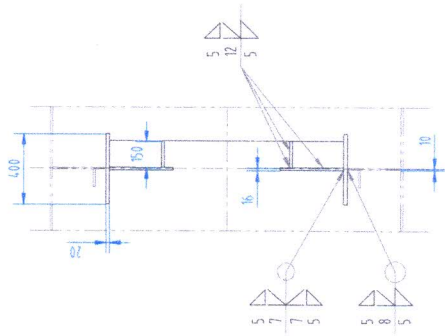

Item	Description	Qty	Weight/pc	Total Weight	Material
11	PL20x395x450	4	21.4	85.6	S355J0 or equiv
10	PL16x298x395	4	11.5	46	S355J0 or equiv
9	PL16x283x395	4	11	44	S355J0 or equiv
8	PL20x395x423	4	20.2	80.8	S355J0 or equiv
7	PL16x150x289	12	5.4	64.8	S355J0 or equiv
6	PL16x150x700	8	13.2	105.6	S355J0 or equiv
5	PL20x400x5070	4	318.4	1273.6	S355J0 or equiv
4	PL16x1310x1360	4	158.7	634.8	S355J0 or equiv
3	PL16x150x1360	8	25.6	204.8	S355J0 or equiv
2	PL20x395x448	8	21.3	170.4	S355J0 or equiv
1	PL16x296x395	8	11.4	91.2	S355J0 or equiv
Total				3112.8	

INDEX		DATE		NAME		DESCRIPTION	
CUSTOMER	P.P.A.			DATE	NAME	SCALE	UNIT
PROJECT	S.T.S. PANAMAX (3 Pcs)			DRAWN BY	CHECKED BY	APPROVED	DATE
OBJECT	Διαδικασία Επισκευής Detail D of M5243 Sheet 1			MATERIAL	WEIGHT	SIZE	REV
REVISION	3. ROKAS JTC - 5/23/2023			GROUP No	DRAWING No	SIZE	REV
REPLACES	F0013 1050 N5241			GROUP No	DRAWING No	SIZE	REV
	REPLACES			GROUP No	DRAWING No	SIZE	REV